

# GRADING PLAN

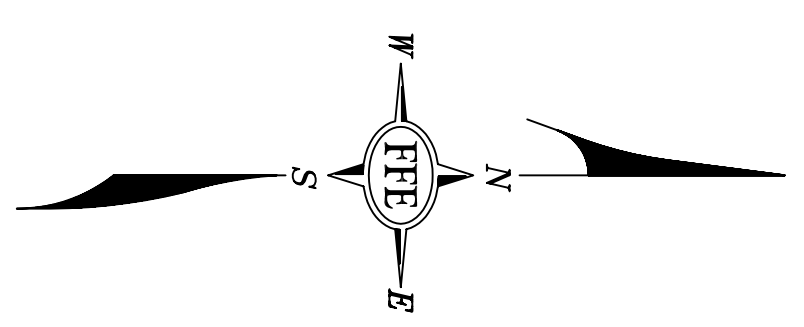
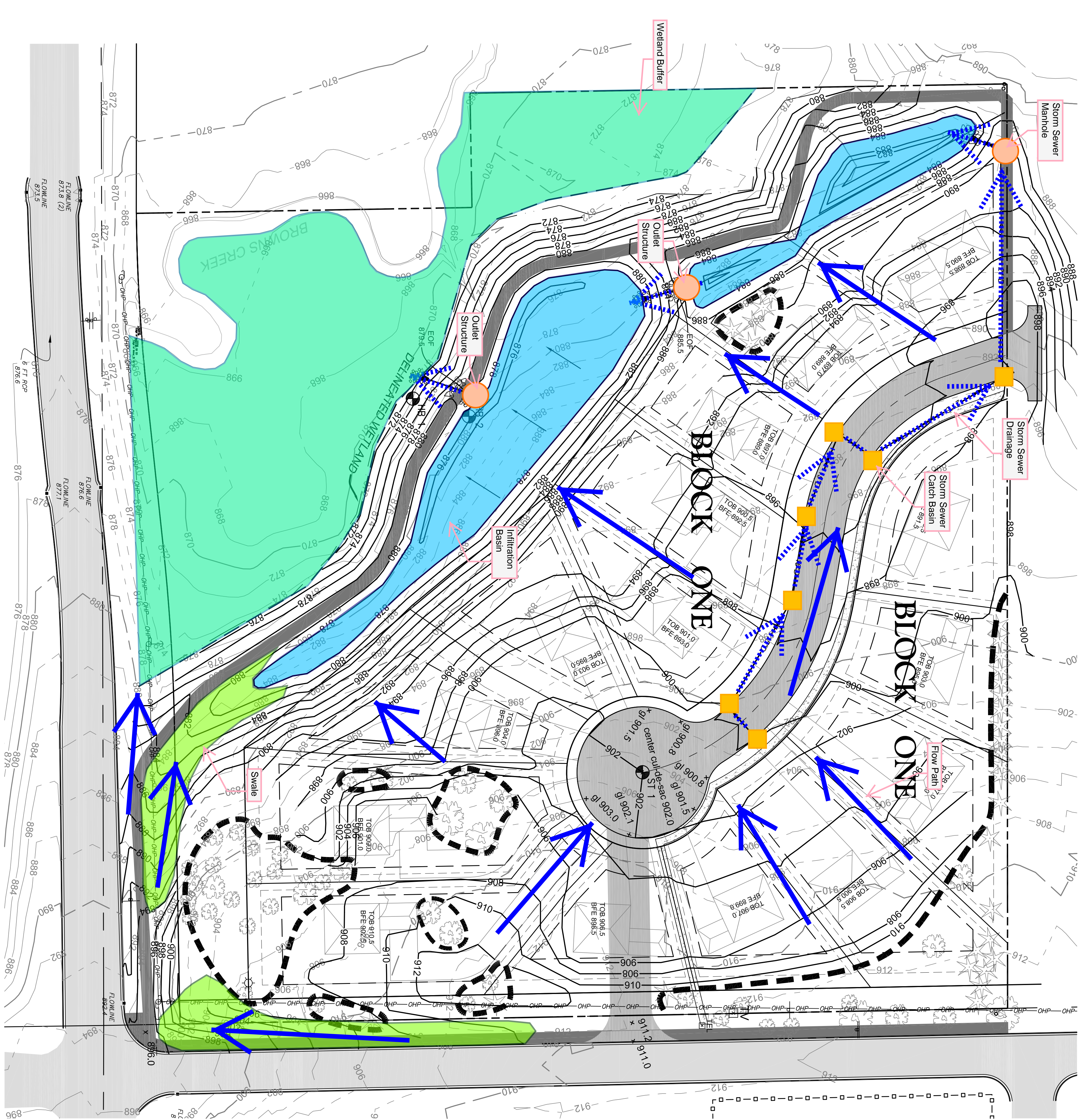

## LEGEND

- 94.0' --- EXISTING CONTOURS
- 93.5' --- PROPOSED CONTOURS
- 12" ST --- EXISTING STORM SEWER W/ M.H., C.B. & F.E.S.
- 12" ST --- PROPOSED STORM SEWER W/ M.H., C.B. & F.E.S.
- HEAVY DUTY SILT FENCING
- TREE FENCING (ORANGE)
- GROUND ELEVATION AT TOP OF WALL
- BW XXXX --- GROUND ELEVATION AT BOTTOM OF WALL
- TW XXXX --- ROCK RETAINING WALL
- CEDAR SPLIT RAIL FENCE (TOP OF RET. WALL)
- TOB --- ELEVATION @ TOP OF BLOCK
- BFE --- BASEMENT FLOOR ELEVATION

## NOTES

- 1) PRIOR TO ROUGH GRADING, INSTALL SILT STOP FENCE IN LOCATIONS SHOWN OR AS DIRECTED BY THE ENGINEER OR CITY STAFF.
- 2) ROUGH GRADING SHALL PROCEED ON AN AREA BY AREA BASIS TO MINIMIZE UNCOMPLETED AREAS.
- 3) AS EACH AREA OUTSIDE THE STREET IS GRADED, PROVIDE # 4 OF NATIVE TOPSOIL, SEED AND MULCH ANCHORED WITH A STRAIGHT SET DISC WITHIN 48 HOURS OF FINE GRADING.
- 4) SLOPES 3:1 AND GREATER SHALL BE STABILIZED WITH FIBER BLANKET.
- 5) MAINTAIN AND REPAIR SILT STOP FENCES (INCLUDING REMOVAL OF ACCUMULATED SILT) UNTIL VEGETATION IS ESTABLISHED.
- 6) CONTRACTOR TO INSPECT AND DOCUMENT EROSION CONTROL WEEKLY AND AFTER ANY RAIN EVENT. DISCOVERED FOUND DAMAGE MUST BE REPAIRED OR REPLACED WITHIN 24 HOURS OF DISCOVERY.
- 7) ALL SEDIMENT CONTROL FEATURES MUST BE REPAIRED WHEN THE SEDIMENT REACHES 1/3 THE HEIGHT OF THE STRUCTURE, OR REPLACED WITHIN 24 HOURS OF DISCOVERY.
- 8) WHEN THE DEPTH OF THE SEDIMENT REACHES 1/2 THE HEIGHT OF THE STORAGE VOLUME, THE BASIN SHALL BE DRAINED AND THE SEDIMENT REMOVED IN A MANNER AS APPROVED BY THE CITY ENGINEER.
- 9) REMOVAL OF SILT FENCE REQUIRED AFTER SITE IS STABILIZED (AT DIRECTION OF ENGINEER).
- 10) ALL EXISTING CITY STREETS SHALL BE SWEEP ON A DAILY BASIS.
- 11) SEE SPECIFICATIONS FOR SWPPP.
- 12) TREE PROTECTION FENCE TO BE INSTALLED AS DIRECTED BY THE ENGINEER IN THE FIELD.

NO.	REVISION DESCRIPTION	DATE	DRAWN	CHECKED
3	REVISED TRAIL	12-11-06	VJV	TAE
2	REVISED WATERSHED SUBMITTAL #2	8-4-06	VJV	TAE
1	REVISED WATERSHED SUBMITTAL	8-1-06	VJV	TAE

I HEREBY CERTIFY THAT THIS PLAN SPECIFICATION OR BY ME OR UNDER MY DIRECT SUPERVISION AND THAT I AM A PROFESSIONAL ENGINEER UNDER THE LAWS OF THE STATE OF MINNESOTA.

**TODD A. ERICKSON**  
40418  
LICENSE NO.  
DATE

DESIGNED BY: TAE  
DRAWN BY: VJV  
CHECKED BY: TAE  
DATE: 03-15-08  
SCALE: 1" = 40'

**Folz, Freeman, Erickson, Inc.**  
LAND PLANNING SURVEYING ENGINEERING  
5620 MEMORIAL AVENUE NORTH, STILLWATER, MN 55082  
Phone (651) 439-8833 Fax (651) 430-9331  
Website: www.ffe-inc.com

**OWNER/DEVELOPER**  
C3 LAND DEVELOPMENT LLC  
**OWNER'S ADDRESS**  
10790 NORWOOD AVE. N.  
STILLWATER, MN 55082

**SHEET NAME**  
GRADING PLAN  
**PROJECT NAME**  
BROWNS CREEK RESERVE  
STILLWATER, MN

SHEET NO.  
**C4.1**  
SHEET 4 OF 14